

AIR FORCE



OUTDOOR RECREATION  
KIRTLAND AIR FORCE BASE

# OUTDOOR RECREATION

ADVENTURE IS CALLING.



2024  
WINTER / SPRING

KIRTLAND AIR FORCE BASE  
 **FORCE**  
SUPPORT SQUADRON

# 377<sup>TH</sup> FORCE SUPPORT SQUADRON

## LEISURE & RECREATION

Aero Club	846-1072
Arts & Crafts	853-3003
Auto Hobby Shop	846-1104
Bowling	846-6851
East Fitness Center	846-1102
Golf Course	846-1169
ITT Ticket Sales	846-2924
Outdoor Recreation	846-1499
Outdoor Adventures	846-1499
FamCamp	846-0337
RV Storage	846-1499
Indoor Pool	846-5485
Outdoor Pool	846-5821

## DINING

Sparetime Gril	846-1156
Golf Course	846-1169
Thunderbird Inn	846-8048/ 846-8049

## FAMILY SERVICES

Military & Family Readiness	846-0741
Gibson CDC	846-1103
Maxwell CDC	853-5521
Youth Center	853-5437
Family Child Care	846-1802

## OTHER SERVICES

Civilian Personnel	846-9556
Education Center	846-9933 846-8955
Honor Guard	846-1804
NAF Human Resources	846-1522
Lodging	846-9653
Marketing/Sponsorship	853-1215
Military Personnel	846-0741 846-0751
Resource Management	846-0405
UNITE Program	846-2439

# THE BEST WAY TO STAY INFORMED



## 377<sup>TH</sup> FORCE SUPPORT SQUADRON THE BLAST

Aero Club	Fitness Center
Military & Family Readiness	Tijeras Arroyo Golf Course
Arts & Crafts	Outdoor Recreation
Auto Hobby Shop	Information, Travel & Ticket
Kirtland Lanes Bowling	Child Development Center
	Youth Center

**KIRTLAND**  **FORCESUPPORT.com**



Follow us on



Comments?  
377svsmarketing@us.af.mil

# TABLE OF CONTENTS

- 2** ACCOUNT CREATION
- 3** OUTDOOR RECREATION
- 4** AQUATICS
- 5** RV STORAGE
- 6** FAMCAMP
- 7** BOULDER LAB
- 8** OUTDOOR ADVENTURE PROGRAM
- 9** VOLUNTEERS
- 10** R4R ELIGIBILITY
- 11** BIKE & SNOW SPORT MAINTENANCE
- 12** SAMPLE RENTAL CONTRACT

- 13** EQUIPMENT RENTALS
- 13** BIKES
- 14** BOUNCE CASTLES
- 16** CAMPING
- 17** CONCESSIONS
- 18** FISHING, LAWN & GARDEN
- 19** LAWN & GARDEN CONT., MISCELLANEOUS & PARTY
- 20** SNOW SPORTS & SPECIAL EVENTS
- 21** SPORTS & GAMES
- 22** SPORTS & GAMES CONT.
- 23** WATER SPORTS
- 24** CAMPING TRAILERS
- 26** UTILITY TRAILERS

 [FACEBOOK.COM/KIRTLANDODR](https://www.facebook.com/kirtlandodr)

 [INSTAGRAM.COM/KIRTLANDODR](https://www.instagram.com/kirtlandodr)

 [KIRTLANDFORCESUPPORT.COM/OUTDOOR-RECREATION](https://www.kirtlandforcesupport.com/outdoor-recreation)

A person wearing a backpack and a hat is hiking on a sandy path in a desert canyon. The canyon walls are composed of layered, reddish-brown rock. A large, gnarled, leafless tree stands on the right side of the path. The sky is clear and blue.

# ROAM FREE

Experience the beauty of nature and push yourself to new limits with Outdoor Recreation. Whether you're scaling cliffs or navigating rivers, these activities provide a sense of freedom and renewal. Through Outdoor Adventure Programs, you can join a community that values sustainable practices and works to preserve our precious environment.

AIR FORCE



**OUTDOOR RECREATION**  
KIRTLAND AIR FORCE BASE

## HOURS

### **Mon- Fri**

9 A.M. to 6 P.M.

### **Sat**

9 A.M. to 1 P.M.

### **Sun & Holidays**

Closed

**Closed every 3rd Thu of each month for training**

## CONTACT & LOCATION

846-1499

The CORE, Bldg. 20170

## OUR FACILITIES ARE AVAILABLE TO ALL TEAM KIRTLAND!

- ☑ Kirtland Swimming Pools
- ☑ RV Storage Lot
- ☑ Family Campground
- ☑ 1,500 sq ft Indoor Boulder Lab
- ☑ Full-service Ski Shop
- ☑ Full-service Bike Shop
- ☑ Equipment Rental
- ☑ Trips, lessons, clinics
- ☑ Custom group trips/tours

OUTDOOR RECREATION

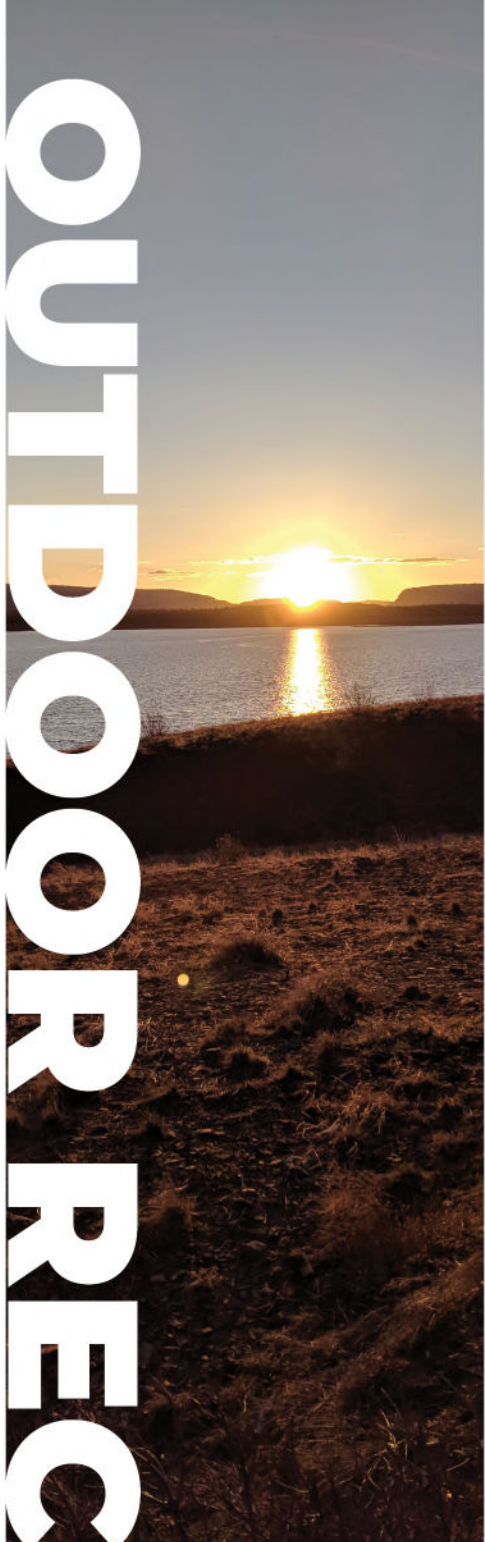



INDOOR & OUTDOOR



# Indoor Pool

**BLDG 20229**

## HOURS OF OPERATION:

Mon-Fri,  
Lap Swim, 6-9 a.m.  
Lap Swim, 11 a.m. to 2 p.m.  
Open Swim, 5-8 p.m.

Sat, Sun & Holidays  
Lap Swim, 10 a.m. to 1 p.m.  
Open Swim, 1-4 p.m.

**CALL 846-5485 FOR QUESTIONS AND/OR UPDATED POOL INFORMATION.**

**ADULTS: \$3**

**CHILD: \$2**

ACTIVE DUTY FREE FOR PT TRAINING ONLY

# Outdoor Pool

**BLDG 22014**

## HOURS OF OPERATION:

Open Memorial Day through Labor Day

**CALL 846-5821 FOR SUMMER HOURS OF OPERATION**

**CASH ONLY**

**ADULTS: \$3**

**CHILD: \$2**



## HOURS OF OPERATION

Mon- Fri  
9 a.m. to 5 p.m.

## CONTACT INFORMATION

**PHONE:** 846-1499 or (505)525-9032

**EMAIL:** kirtland.odr@us.af.mil

## PRICE RATES

12'	\$30/mo
16'-40'	\$45/mo
45'	\$55/mo

## STORE YOUR RV

**WHAT WE NEED:  
BOTH DOCUMENTS WITH YOUR  
NAME ON THEM:**

1. Registration of vehicle being stored
- Insurance of vehicle being stored  
*(must include comprehensive)*
2. If military, copy of your orders

**ORDER OF PRIORITY:**  
*(all must live within 100 miles of KAFB)*

1. Active duty (on or off base)
2. Reserve guard active status
3. Retired military
4. DoD civilians

## MAIL PAYMENTS

OUTDOOR RECREATION  
377 F55/FSWO  
1551 FIRST. ST. SE  
BUILDING 20350, 2D FLOOR  
KIRTLAND AFB, NM 87117

# RV STORAGE

# FAMCAMP

KIRTLAND AIR FORCE BASE

## KIRTLAND AIR FORCE BASE FAMCAMP

### HOURS

#### Mon- Fri

8 A.M. to 4:30 P.M.

*Weekend and after hours self service located in the front of the FamCamp office. Host on site for after hours assistance.*

### CONTACT

846-0337

### AMENITIES

- Coin Ran Laundry Room
- Bathrooms
- Shower Facility
- Propane Service
- Dog Park
- Pet Wash Station
- Playground

### PRICING DAILY

**Full Hook Up** \$35

**Dry/Tent Camping** \$20

### MAP







## HOURS

### Mon- Fri

9 A.M. to 6 P.M.

### Sat

9 A.M. to 1 P.M.

### Sun, Holidays & Training Days

Closed

## RATES & MEMBERSHIP

	Adult	Children (12 and under)
Day Pass:	\$7	\$5
10 Punch Card:	\$50	\$50
1 Month Membership:	\$40	\$35
3 Month Membership:	\$90 (~\$30/Month)	\$65 (~\$22/Month)
6 Month Membership:	\$140 (~\$23/Month)	\$100 (~\$16/Month)
Annual Membership:	\$250 (~\$21/Month)	\$175 (~\$15/Month)

## PRIVATE BOOKING

*Closed to Public*

\$160 up to 2 hours

\$50 each additional hour

INDOOR CLIMBING

# BOULDER LAB

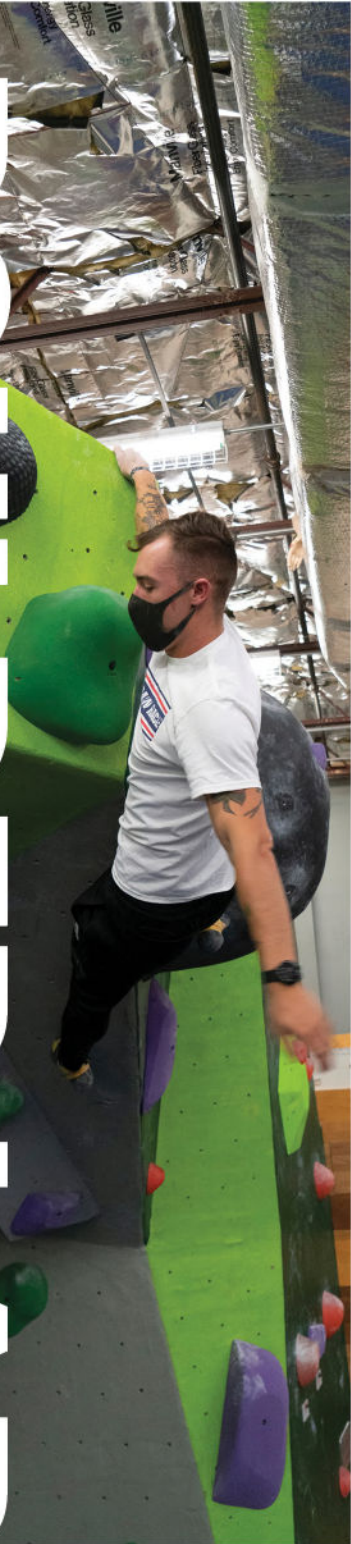



PROGRAMS

Looking for something to do? Check out our calendar of outdoor adventures. We offer everything from educational clinics to introductory outings and once in a lifetime expeditions.

**CHECK  
OUT TRIPS  
HERE!**



**FOR QUESTIONS REGARDING  
TRIPS, CONTACT US AT**  
[kirtland.oap@gmail.com](mailto:kirtland.oap@gmail.com)  
846-1499



Join an adventurous community that likes to create and share experiences.

Outdoor Recreation offers various administrating and guiding opportunities. Volunteering is a great way to learn more about equipment and gain outdoor recreational experiences.

Opportunities include photography, equipment upkeep, white water trips, skiing/snowboarding, climbing, hiking, biking and more.

#### **BENEFITS CAN INCLUDE:**

- ☑ Opportunity to go on outdoor adventure programs as a guide or assistant.
- ☑ Upon request, receive a letter of appreciation including the hours volunteered and the vital service performed on behalf of ODR and the USAF.
- ☑ Learn lifelong skills you can take with you anywhere.

Outdoor Recreation isn't just the brick in its building...it's the people. ODR is a place that is made up of people who may be staff members, interns, volunteers, or participants. Volunteers are tasked with maintaining high standards of professionalism, and have a crucial role in helping ODR continue to build on the solid reputation that has been founded over the years.

#### **CONTACT US TO FIND OUT ABOUT OPPORTUNITIES!**

[kirtland.oap@gmail.com](mailto:kirtland.oap@gmail.com)  
846-1499

 [FACEBOOK.COM/KIRTLANDODR](https://www.facebook.com/kirtlandodr)

 [INSTAGRAM.COM/KIRTLANDODR](https://www.instagram.com/kirtlandodr)

OPPORTUNITIES

VOLUNTEERS

AIR FORCE



SINGLE  AIRMAN

**REC\*ON**  
FEED YOUR RUSH

**DEPLOYED**  
**AFFECTED**  
program

RECHARGE FOR RESILIENCY

ARE YOU...

# R4R

## ELIGIBLE?

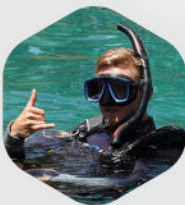
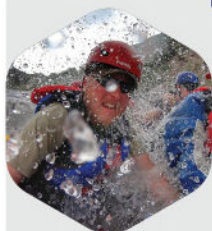

### SINGLE AIRMAN PROGRAM (SAP)

This program provides resources that foster a strong culture, mission and sense of community among Airmen stationed at Kirtland on unaccompanied orders, regardless of rank or marital status. This program offers free or heavily discounted events to anyone with unaccompanied orders here at Kirtland.

*\*Open to single airmen (unmarried) Air Force Active Duty members and one guest*

### RECON

This program provides resources for outdoor-centric, high adrenaline, post deployment stress reduction, only available through FSS Outdoor Recreation Centers. This program offers free or heavily discounted events to active duty members stationed here at Kirtland and their dependents are eligible. Examples of RecOn events in the past have been White Water Rafting, Skydiving, Rock Climbing, and more!

*\*Open to Air Force Active Duty, Reservists and their immediate family members.*

### DEPLOYED AFFECTED PROGRAM (DAP)

This program is for the family of a deployed service member. The deployed service member and their families may also attend the event up to a year after their return! This program offers heavily discounted events to those affected by deployment.

*\*Deployment orders required. (4 months prior to deployment & up to one year following deployment. Open to spouse plus one guest while member is deployed.)*

WHAT IS

# R4R?

**Recharge for Resiliency (R4R) is an Air Force-wide program designed to connect airmen and their families with people of similar interests through fun and challenging programs. R4R encompasses the following key resiliency components: the Single Airman Programming (SAP), RecOn and Deployed Affected Programming (previously R4R). These resiliency programs target specific audiences and provide needed support for our Airmen and their families.**



## TUNE UP SERVICES

### Inspection.....\$15

(Inspection of major systems and evaluation of repair work)

### Basic Tune.....\$35

(Same as Inspection plus minor adjustment and minor lubrication of shifting, brake, and drivetrain systems)

### Performance Tune.....\$50

(Same as Basic tune plus adjustment of bearing assemblies, lubrication of cables, trimming of cable housings, and truing of wheels)

### Overhaul.....\$65

(Same as Performance tune plus cleaning and rebuilding of all bearing assemblies and deep cleaning and lubrication of each bicycle component. The Overhaul will bring your bike to as-close-to-new condition as possible!)

### Misc. Repair Work.....\$25/hour

(Repairs, part replacement, or other services not listed)

A \$25 cleaning fee will apply to dirty bikes.

Prices do not include cost of replacement parts or disc-brake bleeding.



## FLAT REPAIR SERVICES

### Standard Tube .....\$12 each

### Thorn Resistant Tube .....\$15 each

### Tire Liner .....\$12 each

(Plastic liner installed between tire and tube)

### Tire Sealant .....\$5-\$7/tire

(Regardless of tube type, sealant is highly recommended as flat insurance in the goat head country of NM)



### Machine Hot Wax.....\$8

### Hand Hot Wax.....\$18

### Ski/ Snowboard Basic Tune-Up.....\$30

(base grind, edges sharpened, hand hot wax)

### Repair Tune.....\$40

(minor P-Tex repair, base grind, edges sharpened, hand wax)

### Edges Sharpened.....\$10

(Base and sides edges machine ground)

### Base Weld (each).....\$15

(in-conjunction with a repair tune)

### Minor Top Sheet Repair.....\$5

### De-lamination Repair.....\$25

### Binding Adjustment & Function Test\*.....\$25

### Binding Mount & Function Test\*.....\$35

### Snowboard Binding Mount\*.....\$10

### End of Season Tune and Wax.....\$25

### Start of Season de-Wax.....\$5

\*Both boots required for the service

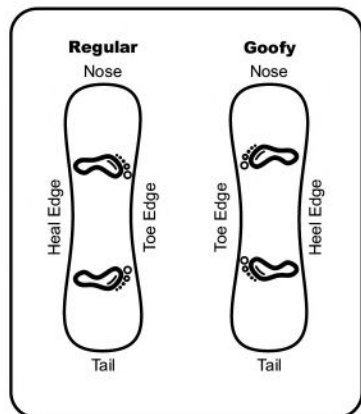

# SAMPLE RENTAL CONTRACT

---

READ THIS DOCUMENT COMPLETELY BEFORE SIGNING. DO NOT SIGN THIS FORM UNLESS YOU FULLY UNDERSTAND ITS TERMS AND OBLIGATIONS. By signing this rental contract/waiver the customer understands and agrees to all of the terms and conditions herein.

1. Equipment may be picked up any time during normal business hours on the pick-up date.
2. Items that are reserved require 50% payment at the time of reservation that is NOT REFUNDABLE. The remaining balance will be paid in full at the time of item pick-up.
3. I understand that I will not receive any refund if I return rental equipment before the indicated return date on this form.
4. Each user is responsible for checking equipment before leaving ODR.
5. After the rental equipment leaves ODR, the customer is responsible for the items until returned, and inspected by ODR staff, whether or not the equipment is used. Customer agrees to pay Full Replacement Cost for ANY lost, stolen, or damaged items.
6. No refunds will be given in the event that equipment cannot be used due to inclement weather, acts of God, or unsuitable conditions.
7. Equipment rental begins at the time of issue and must be returned on the due date no later than 1400 hours (2 PM) on Mon-Fri, and 1300 (1 PM) on Sat.
8. Equipment received after these hours will be considered late and will be charged. Late fees equal to the 1st-day rate of each rental item will be charged for each day the equipment is late. A late fee will be charged on ALL late returns. NO Exceptions!
9. All equipment must be returned in the same condition as issued; clean, dry, and with all pieces. The customer is responsible for setting up equipment upon return.
10. A minimum \$50 service/fix fee. a cleaning fee will apply to all items returned dirty or wet. All equipment must be returned in the same condition it was provided (i.e., rolled, organized, clean, dry, and racked). Trailers and larger items can incur extra charges on top of the fixed fee such as part costs, staff time, etc.
11. All Rental equipment must be returned to ODR staff during office hours. Rental equipment may not be left unattended outside the facility.
12. Primary Household Members are responsible for all equipment rented by additional household members on their account.

---

**Customers must check in with an ODR staff member before loading and unloading equipment.**

---

All equipment is checked periodically for any mechanical/aesthetic issues and is noted and/or logged. No reimbursement will be issued, should any alterations/modifications be made.

## **Personal Property/Liability:**

*I understand that ODR, 377 Force Support Squadron, nor their agents are responsible for loss or damage to personal property and will not be held liable for personal injury.*

*Training Requirements: Customers must provide training documentation prior to renting, White Water Kayaks. ODR staff will verify training requirements.*

*By signing below; I acknowledge that I have read and understood all of the statements and conditions herein.*

[FRSTNAME], [LASTNAME]



DAILY SAT-MON FRI-MON WEEKLY

## BIKES

	DAILY	SAT-MON	FRI-MON	WEEKLY
Bike Trailer	\$10	\$15	\$25	\$50
Commuter Bike	\$10	\$15	\$25	\$50
Helmet (Bike)	\$5	\$7.50	\$12.50	\$25
Hitch (Bike Rack)	\$10	\$15	\$25	\$50
Kick Bike	\$2	\$3	\$5	\$10
Kids Mountain Bike	\$10	\$15	\$25	\$50
Lock (Bike)	\$3	\$4.50	\$7.50	\$15
Mountain Bike (Downhill)	\$35	\$52.50	\$87.50	\$175
Mountain Bike (Hardtail)	\$25	\$37.50	\$62.50	\$125
Road Bike	\$20	\$30	\$50	\$100
Toddler Bike (Training Wheels)	\$3	\$4.50	\$7.50	\$15
Tricycle	\$10	\$15	\$25	\$50

MOUNTAIN BIKE



ROAD BIKE



TRICYCLES



BIKE (ELLSWORTH)



CLASSIC BIKE



EQUIPMENT RENTALS: **BOUNCE CASTLES**

	DAILY	SAT-MON	FRI-MON	WEEKLY	NOTES
<b>BOUNCE CASTLES</b>					
Blower (No Castle)	\$10	\$15	\$25	\$50	Blower
Pub Tavern	\$190	\$285	\$475	\$950	Extra Large - 25x18x14
Tiger Slide	\$190	\$285	\$475	\$950	Extra Large - 34x40x16
Double Slide	\$190	\$285	\$475	\$950	Extra Large - 34x40x16
Obstacle Course	\$190	\$285	\$475	\$950	Extra Large - 35x16x16
Prince Throne	\$25	\$37.50	\$62.50	\$125	Extra Small - (Chair)
Princess Throne	\$25	\$37.50	\$62.50	\$125	Extra Small - (Chair)
Balloon Slide	\$115	\$172.50	\$287.50	\$575	Large - 16x21
Frozen Slide	\$115	\$172.50	\$287.50	\$575	Large - 16x21
Medieval Slide	\$115	\$172.50	\$287.50	\$575	Large - 16x21
Matt Molloy Pub	\$115	\$172.50	\$287.50	\$575	Large - 17x15x17
Castle Combo #1	\$115	\$172.50	\$287.50	\$575	Large - 20x20
Castle Combo #2	\$115	\$172.50	\$287.50	\$575	Large - 20x20
Joust	\$115	\$172.50	\$287.50	\$575	Large - 20x20
Jungle Playground	\$115	\$172.50	\$287.50	\$575	Large - 20x20
Modular Arched Combo	\$115	\$172.50	\$287.50	\$575	Large - 20x20
Basketball Shootout	\$105	\$157.50	\$262.50	\$525	Medium - 12x12
Birthday Cake	\$105	\$157.50	\$262.50	\$525	Medium - 13x13
Boxing	\$105	\$157.50	\$262.50	\$525	Medium - 13x13
Dragon	\$105	\$157.50	\$262.50	\$525	Medium - 13x13
My Little Pony	\$105	\$157.50	\$262.50	\$525	Medium - 13x13
Prince	\$105	\$157.50	\$262.50	\$525	Medium - 13x13
Princess	\$105	\$157.50	\$262.50	\$525	Medium - 13x13
Rocket	\$105	\$157.50	\$262.50	\$525	Medium - 13x13
Twister	\$105	\$157.50	\$262.50	\$525	Medium - 13x13
Wak-A-Mole	\$105	\$157.50	\$262.50	\$525	Medium - 13x13
Balloon Bounce	\$105	\$157.50	\$262.50	\$525	Medium - 15x15
Crayon	\$105	\$157.50	\$262.50	\$525	Medium - 15x15
Magic Castle	\$105	\$157.50	\$262.50	\$525	Medium - 15x15
Modular Arched Unit	\$105	\$157.50	\$262.50	\$525	Medium - 15x15



	DAILY	SAT-MON	FRI-MON	WEEKLY	NOTES
RBY Castle	\$105	\$157.50	\$262.50	\$525	Medium - 15x15
Soccer Dart	\$105	\$157.50	\$262.50	\$525	Medium - 7x13x10
Super Star Blast Zone	\$60	\$90	\$150	\$300	Small - 13x11x7
Little Bopper Blast	\$60	\$90	\$150	\$300	Small - 6x6x5
Jump-N-Slide	\$60	\$90	\$150	\$300	Small - 8x12x7
Fun House #1	\$60	\$90	\$150	\$300	Small - 8x8
Fun House #2	\$60	\$90	\$150	\$300	Small - 8x8
Jump-N-Play	\$60	\$90	\$150	\$300	Small - 9x12x7

**DRAGON**  
13'x13'



**BALLOON SLIDE**  
21'x16'



**MEDIEVAL SLIDE**  
21'x16'



**FROZEN SLIDE**  
21'x16'



**DOUBLE SLIDE**  
31'x17'x18'  
on trailer



**BIRTHDAY CAKE**  
13'x13'

**OBSTACLE COURSE**  
31'x17'x18'  
on trailer



**BASKETBALL SHOOT OUT**  
12'x12'



**AVAILABLE FOR RESERVATIONS UP TO 30 DAYS IN ADVANCE.**

EQUIPMENT RENTALS: **CAMPING**

	DAILY	SAT-MON	FRI-MON	WEEKLY
<b>CAMPING</b>				
Backpack	\$8	\$12	\$20	\$40
Backpack Kid Carrier	\$25	\$37.50	\$62.50	\$125
Burner Stove (Double)	\$10	\$15	\$25	\$50
Burner Stove (Single)	\$5	\$7.50	\$12.50	\$25
Chair/Stool (Camping)	\$3	\$4.50	\$7.50	\$15
Coffee Maker (Camping)	\$5	\$7.50	\$12.50	\$25
Cooler (Camping)	\$5	\$7.50	\$12.50	\$25
Cot	\$8	\$12	\$20	\$40
Fire Pit (Propane)	\$12	\$18	\$30	\$60
Fire Pit (Wood)	\$10	\$15	\$25	\$50
Grill (Camping)	\$7	\$10.50	\$17.50	\$35
Hammock	\$5	\$7.50	\$12.50	\$25
Hatchet	\$3	\$4.50	\$7.50	\$15
Headlamp	\$4	\$6	\$10	\$20
Heater (Electric)	\$5	\$7.50	\$12.50	\$25
Heater (Propane)	\$5	\$7.50	\$12.50	\$25
Lantern (Battery)	\$4	\$6	\$10	\$20
Lantern (Propane)	\$3	\$4.50	\$7.50	\$15
Shovel (Camping)	\$3	\$4.50	\$7.50	\$15
Sleeping Bag	\$9	\$13.50	\$22.50	\$45
Sleeping Pad	\$5	\$7.50	\$12.50	\$25
Table (Camping)	\$5	\$7.50	\$12.50	\$25
Tent (Camping)	\$11	\$16.50	\$27.50	\$55
Treager-Smoker (Camping)	\$12	\$18	\$30	\$60
Trekking Poles	\$5	\$7.50	\$12.50	\$25
Waffle Iron (FirePit)	\$2	\$3	\$5	\$10

DAILY

SAT-MON

FRI-MON

WEEKLY

**CONCESSIONS**

<b>CONCESSIONS</b>	DAILY	SAT-MON	FRI-MON	WEEKLY
Beverage Tub (100 gal)	\$10	\$15	\$25	\$50
Chafing Dishes	\$5	\$7.50	\$12.50	\$25
Coffee Maker	\$4	\$6	\$10	\$20
Coffee Urn	\$4	\$6	\$10	\$20
Cooler (240 QT)	\$10	\$15	\$25	\$50
Cooler	\$5	\$7.50	\$12.50	\$25
Cotton Candy Machine	\$25	\$37.50	\$62.50	\$125
Drink Cambro	\$4	\$6	\$10	\$20
Food Hot Box	\$4	\$6	\$10	\$20
Grill (Backyard Propane)	\$15	\$22.50	\$37.50	\$75
Grill (Charcoal Trailer) 17/8" Ball	\$25	\$37.50	\$62.50	\$125
Grill (Propane Trailer) 2" Ball	\$35	\$52.50	\$87.50	\$175
Grill (Smoker Trailer) 2" Ball	\$35	\$52.50	\$87.50	\$175
Grill (Webber Kettle)	\$20	\$30	\$50	\$100
Popcorn Machine	\$25	\$37.50	\$62.50	\$125
Snow Cone Machine	\$25	\$37.50	\$62.50	\$125
Water Cooler	\$4	\$6	\$10	\$20

AVAILABLE FOR RESERVATIONS UP TO 30 DAYS IN ADVANCE.

EQUIPMENT RENTALS: **FISHING, LAWN & GARDEN**

	DAILY	SAT-MON	FRI-MON	WEEKLY
<b>FISHING</b>				
Fishing Net	\$3	\$4.50	\$7.50	\$15
Fishing Pole (Closed, open, bait cast & fly)	\$8	\$12	\$20	\$40
PFD (Fishing)	\$4	\$6	\$10	\$20
<b>LAWN &amp; GARDEN</b>				
Aerator (Manuel)	\$4	\$6	\$10	\$20
Axe	\$3	\$4.50	\$7.50	\$15
Crescent Wrench (Industrial)	\$3	\$4.50	\$7.50	\$15
Dirt Packer	\$5	\$7.50	\$12.50	\$25
Grass Trimmer / Weedeater	\$5	\$7.50	\$12.50	\$25
Grass Whip	\$3	\$4.50	\$7.50	\$15
Hand Edger	\$3	\$4.50	\$7.50	\$15
Hedge Trimmer	\$8	\$12	\$20	\$40
Hoe	\$3	\$4.50	\$7.50	\$15
Lawn Mower (Gas-Electric)	\$20	\$30	\$50	\$100
Lawn Mower (Manuel)	\$10	\$15	\$25	\$50
Leaf Blower (Electric)	\$5	\$7.50	\$12.50	\$25
Pick	\$3	\$4.50	\$7.50	\$15
Pitch Fork	\$3	\$4.50	\$7.50	\$15
Post Driver	\$4	\$6	\$10	\$20
Post Hole Digger	\$4	\$6	\$10	\$20
Pruner-Shears	\$3	\$4.50	\$7.50	\$15
Rake	\$3	\$4.50	\$7.50	\$15
Rotary Tiller (Large)	\$55	\$82.50	\$137.50	\$275
Rotary Tiller (Small)	\$45	\$67.50	\$112.50	\$225
Saw	\$3	\$4.50	\$7.50	\$15
Seed Spreader	\$3	\$4.50	\$7.50	\$15
Shovel	\$4	\$6	\$10	\$20
Sledge Hammer	\$4	\$6	\$10	\$20

DAILY

SAT-MON

FRI-MON

WEEKLY

**LAWN & GARDEN (CONT.)**

Tamper (Post Hole)	\$3	\$4.50	\$7.50	\$15
Tiller (Manuel)	\$3	\$4.50	\$7.50	\$15
Weed Puller	\$3	\$4.50	\$7.50	\$15
Wheel Barrow	\$5	\$7.50	\$12.50	\$25

**MISCELLANEOUS**

Carpet Cleaner	\$20	\$30	\$50	\$100
Dolly	\$7	\$10.50	\$17.50	\$35
Mega Phone	\$5	\$7.50	\$12.50	\$25
Metal Detector	\$10	\$15	\$25	\$50
Convertible Hand Truck	\$10	\$15	\$25	\$50
Generator	\$60	\$90	\$150	\$300

**PARTY**

Portable Bars	\$30	\$45	\$75	\$150
Beer Pong	\$5	\$7.50	\$12.50	\$25
Big Foot Race	\$15	\$22.50	\$37.50	\$75
Big Foot Race Jr	\$10	\$15	\$25	\$50
Dunk Tank	\$60	\$90	\$150	\$300
High Striker Caterpillar	\$15	\$22.50	\$37.50	\$75
Karaoke Machine	\$12	\$18	\$30	\$60
Photo Booth	\$20	\$30	\$50	\$100
Projector/Screen (Inflatable)	\$35	\$52.50	\$87.50	\$175
Projector/Screen (Metal)	\$35	\$52.50	\$87.50	\$175
Frame Games	\$20	\$30	\$50	\$100
Speakers (Set of 2)	\$10	\$15	\$25	\$50

AVAILABLE FOR RESERVATIONS UP TO 30 DAYS IN ADVANCE.

# EQUIPMENT RENTALS: SNOW SPORTS & SPECIAL EVENTS

	DAILY	SAT-MON	FRI-MON	WEEKLY
<b>SNOW SPORTS</b>				
	ALPINE TOUR SKI PACKAGE & SPLITBOARDS ARE AVAILABLE AS SEASON RENTALS ONLY			
Boots	\$5	\$7.50	\$12.50	\$25
Helmet (Snow)	\$5	\$7.50	\$12.50	\$25
Jacket (Snow)	\$10	\$15	\$25	\$50
Pants (Snow)	\$10	\$15	\$25	\$50
Roof Rack	\$5	\$7.50	\$12.50	\$25
Ski Cross Country (Package)	\$20	\$30	\$50	\$100
Ski Downhill Adult (Package)	\$20	\$30	\$50	\$100
Ski Downhill Kids (Package)	\$10	\$15	\$25	\$50
Ski Poles	\$5	\$7.50	\$12.50	\$25
Skis (Only)	\$15	\$22.50	\$37.50	\$75
Sled (Snow)	\$3	\$4.50	\$7.50	\$15
Snow Shoes (With Poles)	\$10	\$15	\$25	\$50
Snowboard (Only)	\$15	\$22.50	\$37.50	\$75
Snowboard Adult (Package)	\$20	\$30	\$50	\$100
Snowboard Kids (Package)	\$10	\$15	\$25	\$50
Tube (Snow)	\$8	\$12	\$20	\$40
<b>SPECIAL EVENTS</b>				
Canopy Industrial (15x15)	\$50	\$75	\$125	\$250
Canopy Industrial (20x20)	\$60	\$90	\$150	\$300
Canopy pop up (10x10)	\$30	\$45	\$75	\$150
Canopy Side (1)	\$5	\$7.50	\$12.50	\$25
Folding Chair (Regular-Metal)	\$0.50	\$0.75	\$1.25	\$2.50
Folding Chair (Special Event)	\$1	\$1.50	\$2.50	\$5
Table (6FT)	\$4	\$6	\$10	\$20
Table (8FT)	\$5	\$7.50	\$12.50	\$25
Table (Cocktail)	\$4	\$6	\$10	\$20
Table (Round Party)	\$5	\$7.50	\$12.50	\$25

AVAILABLE FOR RESERVATIONS UP TO 30 DAYS IN ADVANCE.

	DAILY	SAT-MON	FRI-MON	WEEKLY
<b>SPORTS &amp; GAMES</b>				
Baseball	\$1	\$1.50	\$2.50	\$5
Basketball	\$1	\$1.50	\$2.50	\$5
Bat	\$1	\$1.50	\$2.50	\$5
Bocce Ball Set	\$3	\$4.50	\$7.50	\$15
Bowling (Yard Set)	\$3	\$4.50	\$7.50	\$15
Checkers (Giant)	\$2	\$3	\$5	\$10
Cones (Traffic 4 set)	\$1	\$1.50	\$2.50	\$5
Cones (Training 10 Set)	\$1	\$1.50	\$2.50	\$5
Connect 4	\$3	\$4.50	\$7.50	\$15
Corn Hole	\$5	\$7.50	\$12.50	\$25
Crash Pad	\$7	\$10.50	\$17.50	\$35
Disc Golf Cage	\$5	\$7.50	\$12.50	\$25
Disc Golf Set (3 Discs & Bag)	\$3	\$4.50	\$7.50	\$15
Dodge Ball	\$1	\$1.50	\$2.50	\$5
Flag Football Set (12x12)	\$10	\$15	\$25	\$50
Football	\$1	\$1.50	\$2.50	\$5
Frisbee	\$1	\$1.50	\$2.50	\$5
Glove (Baseball/Softball)	\$2	\$3	\$5	\$10
Golf Club Set (9 Clubs)	\$5	\$7.50	\$12.50	\$25
Horseshoe Set (2 Stakes 8 Shoes)	\$4	\$6	\$10	\$20
Hula Hoop	\$1	\$1.50	\$2.50	\$5
Jenga (Giant)	\$2	\$3	\$5	\$10
Kan Jam	\$3	\$4.50	\$7.50	\$15
Kickball Set (1 Ball 4 Bases)	\$2	\$3	\$5	\$10
Pickleball Set	\$2	\$3	\$5	\$10

# EQUIPMENT RENTALS: SPORTS & GAMES

DAILY

SAT-MON

FRI-MON

WEEKLY

## SPORTS & GAMES (CONT.)

	DAILY	SAT-MON	FRI-MON	WEEKLY
Potato Sack Race	\$5	\$7.50	\$12.50	\$25
Pug Nets (2 Goals 1 bag)	\$2	\$3	\$5	\$10
Soccer Ball	\$1	\$1.50	\$2.50	\$5
Softball	\$1	\$1.50	\$2.50	\$5
Softball/Baseball Set	\$12	\$18	\$30	\$60
Spike Ball (1 Net 2 Balls)	\$2	\$3	\$5	\$10
Tennis Set (2 Racquets 2 Balls)	\$3	\$4.50	\$7.50	\$15
Tennis Racquet	\$1	\$1.50	\$2.50	\$5
Tug-O-War Rope	\$2	\$3	\$5	\$10
Volleyball	\$1	\$1.50	\$2.50	\$5
Volleyball Set (1 Ball 1 Net)	\$6	\$9	\$15	\$30

SOCCER BALL



SOFTBALL BAT



FLAG FOOTBALL SET



FRISBEE



FOOTBALL



SOFTBALL SET



TENNIS SET



x12

x12

GOLF CLUB SET



HORSESHOES



DISC GOLF SET



RACQUETBALL RACKET





	DAILY	SAT-MON	FRI-MON	WEEKLY
<b>WATER SPORTS</b>				
Canoe (2 or 3 Person)	\$30	\$45	\$75	\$150
Helmet (Water)	\$5	\$7.50	\$12.50	\$25
Inflatable Towable Rider	\$15	\$22.50	\$37.50	\$75
Kayak (Hobie)	\$30	\$45	\$75	\$150
Kayak (Inflatable Single or Double)	\$30	\$45	\$75	\$150
Kayak (Recreational Single or Double)	\$30	\$45	\$75	\$150
Kayak (Touring Single or Double)	\$30	\$45	\$75	\$150
Paddle (ANY)	\$4	\$6	\$10	\$20
PFD (Watersports)	\$3	\$4.50	\$7.50	\$15
River Float Tube	\$8	\$12	\$20	\$40
Stand Up Paddleboard (Inflatable or Ridgid)	\$30	\$45	\$75	\$150
Wakeboard	\$10	\$15	\$25	\$50
Wet Suit	\$10	\$15	\$25	\$50

**PFD (PERSONAL FLOTATION DEVICE/LIFE JACKET)****WAKEBOARD****RIVER FLOAT TUBE****STAND UP PADDLE BOARD****INFLATABLE KAYAK**

Single 10ft



Double 13ft

**INFLATABLE STAND UP PADDLE BOARD**

10ft

## R-POD



2" Ball Hitch - 7 Pin Power Connector - 2700 lb

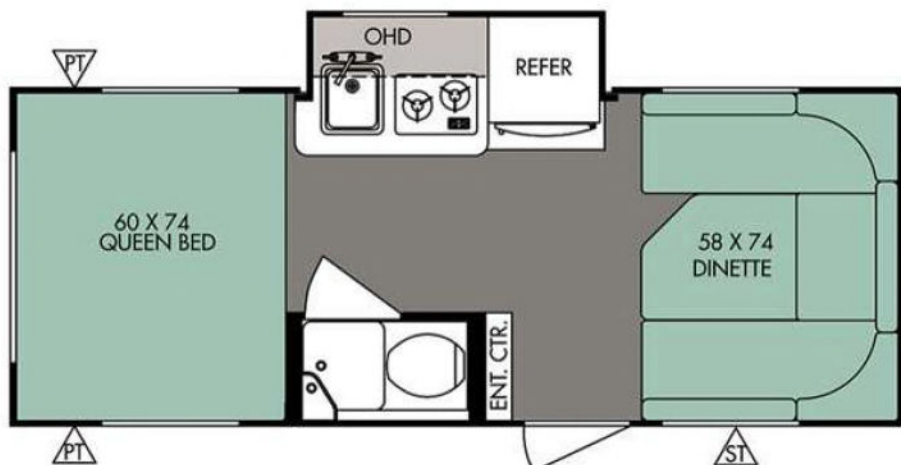

DAILY SAT-MON FRI-MON WEEKLY

CAMPING TRAILERS

Little Guy	\$80	\$120	\$200	\$400
Luna Rover	\$110	\$165	\$275	\$550
R-Pod	\$130	\$195	\$325	\$650
T@B	\$100	\$150	\$250	\$500

AVAILABLE FOR RESERVATIONS UP TO 30 DAYS IN ADVANCE.

T@B

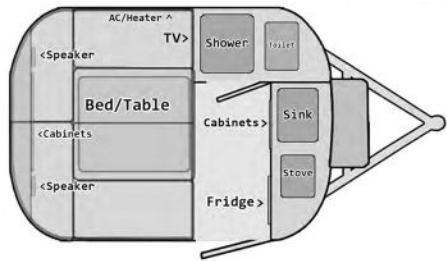

2" Ball Hitch - 7 Pin Power Connector - 2800 lb  
11 ft Cabin (16 ft total length)

LUNA ROVER



LITTLE GUY

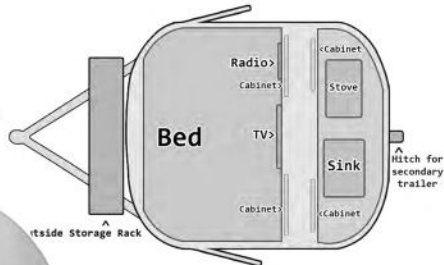

ALL CAMPING TRAILERS REQUIRE A 2" BALL AND 7 PIN CONNECTOR

2" Ball Hitch - 7 Pin Power Connector - 1200 lb - 6 ft Cabin (11 ft total length)

DAILY    SAT-MON    FRI-MON    WEEKLY    NOTES

## CAMPING TRAILERS

Box Trailer	\$60	\$90	\$150	\$300	(2 Ball) (4 Pin)
Canoe Trailer	\$25	\$37.50	\$62.50	\$125	(2 Ball) (4 Pin)
Car Hauler	\$80	\$120	\$200	\$400	(2 5/16 Ball) (7 Pin)
Flatbed - Large	\$60	\$90	\$150	\$300	(2 Ball) (4 Pin)
Flatbed - Large	\$60	\$90	\$150	\$300	(2 5/16 Ball) (4 Pin)
Flatbed - Small	\$50	\$75	\$125	\$250	(2 Ball) (4 Pin)
Kayak Trailer	\$25	\$37.50	\$62.50	\$125	(2 Ball) (4 Pin)

**AVAILABLE FOR RESERVATIONS UP TO 30 DAYS IN ADVANCE.**

### CAR HAULER



### SMALL FLATBED TRAILER



### LARGE FLATBED TRAILER

16 ft. Flatbed  
2 5/16" Ball



### CANOE/KAYAK TRAILER (6 OR 8)



### BOX TRAILER



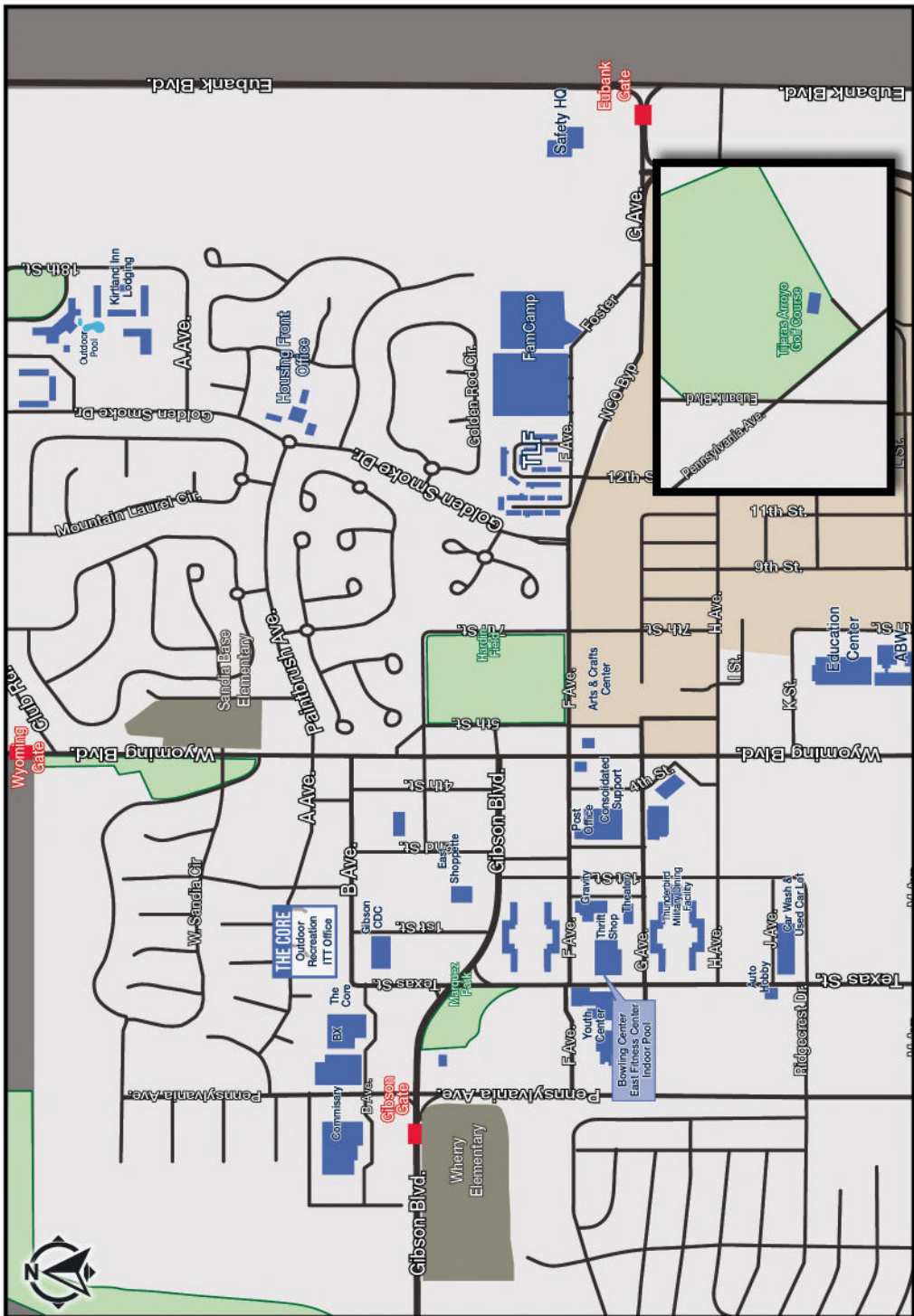







# KIRTLAND

CREDIT UNION

**Financial confidence  
for the 'now' moments  
& the trails ahead.**

*Live Confident.*

[kirtlandcu.org](https://kirtlandcu.org)

**Visit us at the BX Branch today!**

Membership eligibility required. Paid advertisement.

No federal endorsement intended.